

# LOPEZ SOLID WASTE DISPOSAL DISTRICT REGULAR MANAGING BOARD MEETING

## MINUTES

WEDNESDAY, October 18, 2017  
LOPEZ ISLAND FIRE HALL MEETING ROOM  
3:00 PM to 5:00 PM  
Approved 11/15/17

**Board members present:** Clark Johnson, Rhea Miller, Judy Meyer (via Skype), Tytti Langford

**Board member absent:** none

**Others present:** District Manager Paul Andersson, Facilities Manager David Zapalac, Training Education and Outreach Coordinator Nikyta Palmisani, SWAP Co-chair Kim Norton, Larry Bailey, Brad Buchanan, Page Read

Clark called the meeting to order at 3 PM, noting no changes to agenda.

**Rhea moved to approve the minutes from the September 27, 2017 regular meeting with the changes to the draft minutes suggested by Rhea. The motion was approved unanimously.**

**Recycled plastics presentation:** Page and Brad presented a spreadsheet showing three scenarios for how LSWDD could handle plastic recycling (about 40,000 lb/year): 1) continue in the current mode, 2) make and sell 3D printer filament, and 3) make and sell molded plastics. The financial consequences of each depend on the assumptions used. Another alternative would be producing plastic pellets of a single type of plastic that could then be sold. They have received numerous suggestions from Lopezians of things that could be made from recycled plastics including: chopsticks, earring molds, pavers, siding for raised beds, insulation, 4x4 waypoint markers, and downspout splash blocks. Other ideas are welcome at [Info@lopezsolidwaste.org](mailto:Info@lopezsolidwaste.org). The Board discussed costs for providing the equipment needed for the various scenarios and asked about potential for environmental contamination from them. The contaminants in the plastics might produce some odor (based on their thermal properties, the plastics themselves will not), but none of the processes would result in products going into water. The Board thanked Page and Brad for their work on this issue and their thorough and informative presentation, after which Page and Brad left the meeting.

### Board business

**Financial Officer's report:** See Appendix 1 and 2 (below). The following voucher/warrants/electronic payments are approved for payment: Claim numbers:

17031 through 17033, totaling \$19,917.74. Paul will get new estimates for next year's legacy fees. As anticipated in the budget, it is likely that we will have to dip into the cash reserves as revenues decline with fewer customers in the upcoming winter months.

**District Manager's monthly report:** See Appendix 2 (below). The management committee met today to go over the 2018 budget, which the full board will discuss at the October 30 Special Meeting. Employee health insurance contribution will likely be \$150/month per employee. The Board noted that the county per diem rates should be budgeted into the travel budget. Paul has developed a draft survey for volunteers, which he will send to the Board for comments. The ideas about an article about volunteers and volunteer appreciation suggestions were positively received by Carol Steckler, Volunteer Coordinator.

**Administrator's report:** See Appendix 5 (below).

**Facility Manager's monthly report:** See Appendix 3 (below). We have a building permit for the baler shed extension. David will purchase a canopy to shelter our appliances. The waste oil recycler has removed all the waste oil from the site. The Operations Committee is working on a backup plan for what can be done with waste oil. They are also discussing combining appliance grade with other steel, which would make it simpler for our customers. They will present a plan on this for Board approval at a future meeting. Printers can no longer be recycled, and the committee is looking into other options for printers and whether to propose a change in the \$4 charge. Paul has installed four large industrial grade shelves for TIOLI, which should provide space for increased organization.

**Training, Education and Outreach Coordinator's report:** Nikyta shared her work plan for this quarter. Its structure has been changed to clarify the different aspects of her work. The Board is asked to send Nikyta information on homeowner associations. Waste Management in Seattle is interested in what is being done in the ReMake lab and would like to bring a high school group to Lopez to see what we are doing. Eric Blaser has assumed responsibility for periodic weighing of TIOLI intakes and discards.

### **Other reports**

**Solid Waste Alternatives Program:** (1) They have budgeted \$2000 for targeted projects and \$500 for volunteer support in 2018. If LSWDD wants to have donations collected at TIOLI, SWAP will handle the funds. SWAP supports the idea of a volunteer survey so that volunteer appreciation efforts are something that the volunteers will want. (2) There will be a small shirts-to-skirts work party on October 28 and a larger one on November 7. Skirts will be sold at the preschool and Port Stanley bazaars and will be modeled at the High Tea. (3) SWAP's new project is "boomerang bags" which are clean recyclable bags that will be available in bins outside local stores. The idea comes

from Australia and is part of a global effort. (4) SWAP will be sending out a solicitation letter.

**Solid Waste Advisory Committee** is close to approving the new solid waste management plan for the county.

### **New business**

**Volunteer appreciation activities:** Several suggestions were discussed for demonstrating our appreciation to the LSWDD volunteers. The idea that seemed most appropriate for this year is to put an ad in the paper around Thanksgiving listing and thanking our volunteers (Clark agreed to be in charge of this), writing an article for the paper about our volunteers (Paul agreed to do this), and Nikyta will do a thanksgiving tree.

### **Idea pot**

Clark encourages us to develop a long-term vision of what LSWDD intends to become; what do we want the site to look like and how can we make that vision a reality. By the middle of next year, it would be good to have a document that expresses this. He presented a sketch of how the site might be configured (Appendix 4) to stimulate our thinking on the subject.

Judy suggested that we build on the information provided in Page and Brad's presentation and form a committee exploring the future of plastics recycled at the site. She will put it on the agenda for our next regular meeting.

The meeting was adjourned at 5:03 pm. There will be a Special Board Meeting on the 2018 budget on October 30, 2017, and the next regular board meeting is November 15, 2017.

Respectfully submitted,

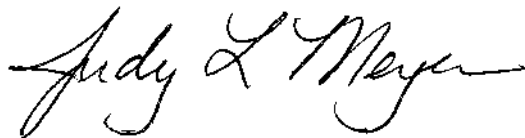

Judy Meyer,  
Secretary  
[judym@lopezsolidwaste.org](mailto:judym@lopezsolidwaste.org)

## APPENDIX 1

|   | Jan - Sep ...     | Budget            | % of Bud...   |
|---|-------------------|-------------------|---------------|
| LSWDD   |                   |                   |               |
| Profit & Loss Budget vs. Actual                 |                   |                   |               |
| January through September 2017                  |                   |                   |               |
|   |                   |                   |               |
| Income  |                   |                   |               |
| Tax Levy Revenue (311.10.00.0000)               | 54,273.37         | 51,056.00         | 106.3%        |
| Timber Harvest Tax Revenue (317.40.00.0000)     | 7.66              |                   |               |
| Excise Tax Revenue (318.45.00.0000)             | 49,753.59         | 43,583.00         | 114.2%        |
| Garbage Tip Fee Revenue (343.70.00.0000)        | 131,979.32        | 113,568.00        | 116.2%        |
| Recyclables Sales Revenue (343.70.00.0001)      | 11,175.82         | 9,240.00          | 121.0%        |
| Recyclables Tip Fee Revenue (343.70.00.0002)    | 7,022.00          | 5,778.00          | 121.5%        |
| Investment Interest, LGIP (361.11.00.0000)      | 1,248.23          |                   |               |
| Donations (367.00.00.0000)                      | 741.41            | 578.00            | 128.3%        |
| Cash Over (Short) (369.81.00.0000)              | 5.96              |                   |               |
| Refuse Tax (386.37.00.0000)                     | 4,739.42          | 4,088.00          | 115.9%        |
| <b>Total Income</b>                             | <b>260,946.78</b> | <b>227,891.00</b> | <b>114.5%</b> |
| Expense   |                   |                   |               |
| Wages (537.00.10.0000)                          | 108,863.63        | 114,852.00        | 94.8%         |
| Overtime (537.00.10.0001)                       | 85.35             |                   |               |
| FICA (537.00.20.0001)                           | 8,137.38          | 8,784.00          | 92.6%         |
| L&I (537.00.20.0002)                            | 5,006.49          | 6,431.00          | 77.8%         |
| Retirement (537.00.20.0003)                     | 10,470.28         | 12,633.00         | 82.9%         |
| Personnel Benefits (537.00.20.0009)             | 87.16             | 230.00            | 37.9%         |
| Office & Operating Supplies (537.00.31.0000)    | 3,001.23          | 2,628.00          | 114.2%        |
| Fuel (537.00.32.0000)                           | 1,411.82          | 3,080.00          | 45.8%         |
| Small Tools & Equipment (537.00.35.0000)        | 1,634.98          | 5,625.00          | 29.1%         |
| Accounting and Professional (537.00.41.0000)    | 100.00            | 2,600.00          | 3.8%          |
| Advertising and Public Outreach (537.00.41.0... | 612.25            | 900.00            | 68.0%         |
| SJC Admin. and Legacy Fees (537.00.41.0099)     | 16,681.01         | 23,814.00         | 70.0%         |
| Communications (537.00.42.0000)                 | 1,697.36          | 1,350.00          | 125.7%        |
| Taxes, Other (537.00.44.0000)                   | 1,192.67          | 990.00            | 120.5%        |
| Rentals and Leases (537.00.45.0000)             | 1,750.00          | 1,800.00          | 97.2%         |
| Insurance (537.00.46.0000)                      | 12,440.46         | 14,500.00         | 85.8%         |
| Utility Services (537.00.47.0000)               | 493.50            | 747.00            | 66.1%         |
| Garbage Tip Fees Paid (537.00.47.0001)          | 35,444.20         | 31,654.00         | 112.0%        |
| Garbage Transportation Exp. (537.00.47.0002)    | 7,221.45          | 6,463.00          | 111.7%        |
| Recyclables Tip Fees Paid (537.00.47.0003)      | 0.00              | 434.00            | 0.0%          |
| Recyclables Transportation Exp. (537.00.47.0... | 6,815.95          | 5,831.00          | 116.9%        |
| Reclamation-Disposal Fees Paid (537.00.47.0...  | 3,067.24          | 3,504.00          | 87.5%         |
| Repairs and Maintenance (537.00.48.0000)        | 3,767.95          | 11,250.00         | 33.5%         |
| Fees & Dues (537.00.49.0001)                    | 240.00            | 153.00            | 156.9%        |
| Hazardous Waste Exp. Allowance (537.00.49....   | 50.00             | 250.00            | 20.0%         |
| Permits and Licenses (537.00.51.0000)           | 1,367.00          | 1,647.00          | 83.0%         |
| Refuse Tax Payment (586.00.44.0000)             | 2,687.65          | 2,267.00          | 118.6%        |
| Debt service, Principal (591.37.70.0000)        | 9,570.64          | 9,750.00          | 98.2%         |
| Interest Expense (592.37.80.0000)               | 582.85            | 580.00            | 100.5%        |
| Facility Improvements (594.37.63.0000)          | 3,803.21          | 28,500.00         | 13.3%         |
| Computer and Software Exp. (594.37.64.0000)     | 529.60            | 747.00            | 70.9%         |
| <b>Total Expense</b>                            | <b>248,813.31</b> | <b>303,994.00</b> | <b>81.8%</b>  |
| <b>Net Income</b>                               | <b>12,133.47</b>  | <b>-76,103.00</b> | <b>-15.9%</b> |

**APPENDIX 2**

# Board Materials – 10/18/17

## Contents

|                                  |   |
|----------------------------------|---|
| Financial Officer’s Report.....  | 6 |
| Manager’s Monthly Report.....    | 6 |
| Management Committee Report..... | 8 |
| Admin Committee Report.....      | 8 |
| PR Committee Report .....        | 8 |
| TIOLI Committee Report .....     | 8 |

## Financial Officer's Report

### 1. Financials – Monthly and YTD summary:

Summary:

We were 25% above budgeted revenues for September and are 14.5% above budgeted revenues for the year through end of September.

Expenditures were 6% below budgeted expenditures for September (adjusted for Legacy Fees, Capital Improvements and Fuel payments which all show zero on the Income Statement but have been incurred) and are 6% below budgeted expenditures for the year (including the same adjustment).

We have \$55,787 in our cash account (plus \$200,000 invested reserves).

If adjusting for the same costs incurred but not yet paid as above, we have \$36,291, which is \$52,538 above budgeted ending cash for the end of September.

(Reference Income Statement and Statement of Cash Flows attached.)

Cash flow scenario through end of 2017 – Paul to provide brief update

### 2. 2018 Budget & Levy

Next steps include

- a) Special Meeting: Monday October 30<sup>th</sup>, 3-5pm
- b) Schedule SJC Council date for budget approval in late November/December
- c) Approve 2018 budget at Regular Meeting in November and receive Governing Board approval in November/December.
- d) Vote YES! on Proposition 1!!

## Manager's Monthly Report

### Documents

Employee Handbook – submitted to Randy Gaylord, SJC for legal review.

### Volunteer Recruitment/Retention

Volunteer survey

Volunteerism news article

## Upgrading the Volunteer Experience

Volunteer Appreciation Week

Reference table of possible volunteer actions

## TIOLI infrastructure

Shelving installed

## Health Insurance research update



## Summary

- Automated software approach, including 3<sup>rd</sup> party administrator duties
- Ensures compliance w/Federal law
- PeopleKeep – 1.5 years on the market, 4000 businesses as customers, 10 years in business.
- Select employees, select benefits –
- Max of \$412/mo per employee or \$4,950/yr
- Required documents include Summary Plan Description and HRA Plan Document
- 1-time account setup fee of \$949 (for 1 person) or \$749 for 5+ people; \$134/mo fee for 7 employees; \$1,608/yr minus 20% for pre-pay = \$1,287



Jeremy Bisco | Group Inside Sales Supervisor

Total Administrative Services Corporation (TASC)

e: [jeremy.bisco@tasconline.com](mailto:jeremy.bisco@tasconline.com)

p: 608.316.2430

f: 608.661.9550



## Management Committee Report

COMMITTEE DID NOT MEET

## Admin Committee Report

COMMITTEE DID NOT MEET

## PR Committee Report

Discussion on next steps on plastics – community discussion, planning meeting, etc.

## TIOLI Committee Report

TIOLI Best Practices document under development.

### **APPENDIX 3**

#### **Solid Waste Facility Manager's Monthly Report**

Date Issued: October 14, 2017

#### ***SAFETY***

A propane shop heater that was pulled out the steel recycling container has been fixed and put into service for the recycle plaza volunteers. It will be fueled by the propane tanks that LSWDD receives which still contain fuel.

#### ***GENERAL***

##### **OPERATIONS/ONGOING ISSUES:**

The Baler shed roof project is still awaiting the building permit, which is expected to be finalized and issued this coming week if the County is still on schedule with it's initial estimate. The Letter of Agreement has been signed with Swallech Construction and we are awaiting an invoice from them for the initial payment that they require prior to construction.

Mark Herrenkhol has informed us that, within the next few weeks, the state Department of Ecology will be sending an employee to the San Juan Islands to inspect the three solid waste sites for Stormwater



Pollution Prevention Plan compliance. Compliance issues that are currently being addressed include the purchase of a rigid canopy to cover the appliance storage area and the proper storage of the high grade metals that are being collected by the Recycle Dog volunteers. The canopy will be ordered this week and the materials remain temporarily covered until the new baler shed roof is in place.

The waste oil collection has been temporarily suspended due to the fact that the storage container is full and the hauler has not come to the island to remove oil from our site or the other two businesses that they service on Lopez Island. Mark Herrenkhol has offered to help find a solution to this problem since the county shop next door is still not wanting to receive our oil and the backup plan, having ORRSCO haul the oil off island, has also failed. An option may be to have the county shop on San Juan island take our oil temporarily, but the approval for this is awaiting the return of the shop manager, who is on vacation.

New and improved filter socks have been installed in the bioswale. The socks were made from materials gathered from TIOLI and are 100% compostable. It is expected that they should last for about a year.

Paul has ordered and installed new shelving for TIOLI to better organize the textile area in the back of the building. The first four units, which each measure 2 feet deep by 4 feet wide, are easy to assemble and can be easily relocated to wherever needed.

Skagit River Steel and Recycling prices for September were:

**Baled Corrugated Cardboard \$60/ton (decrease of \$40 per ton)**

Aluminum Cans \$0.34/lb. (up 2 cents)

Mixed paper \$13/ton (down 2 dollars)

Aluminum Foil \$0.10/lb. (unchanged)

#1-7 mixed plastic \$0.0/lb. (unchanged)

All other plastic containers sold \$0.0/lb. (unchanged)

#### CUSTOMER/VOLUNTEER FEEDBACK:

The situation with the waste oil has left several customers frustrated, but they have all been patient and understanding once the situation was explained. Customers are also commenting on the articles that have appeared in the paper and have generally been positive and hopeful that a solution will be found by LSWDD which will allow them to continue to recycle.

APPENDIX 4

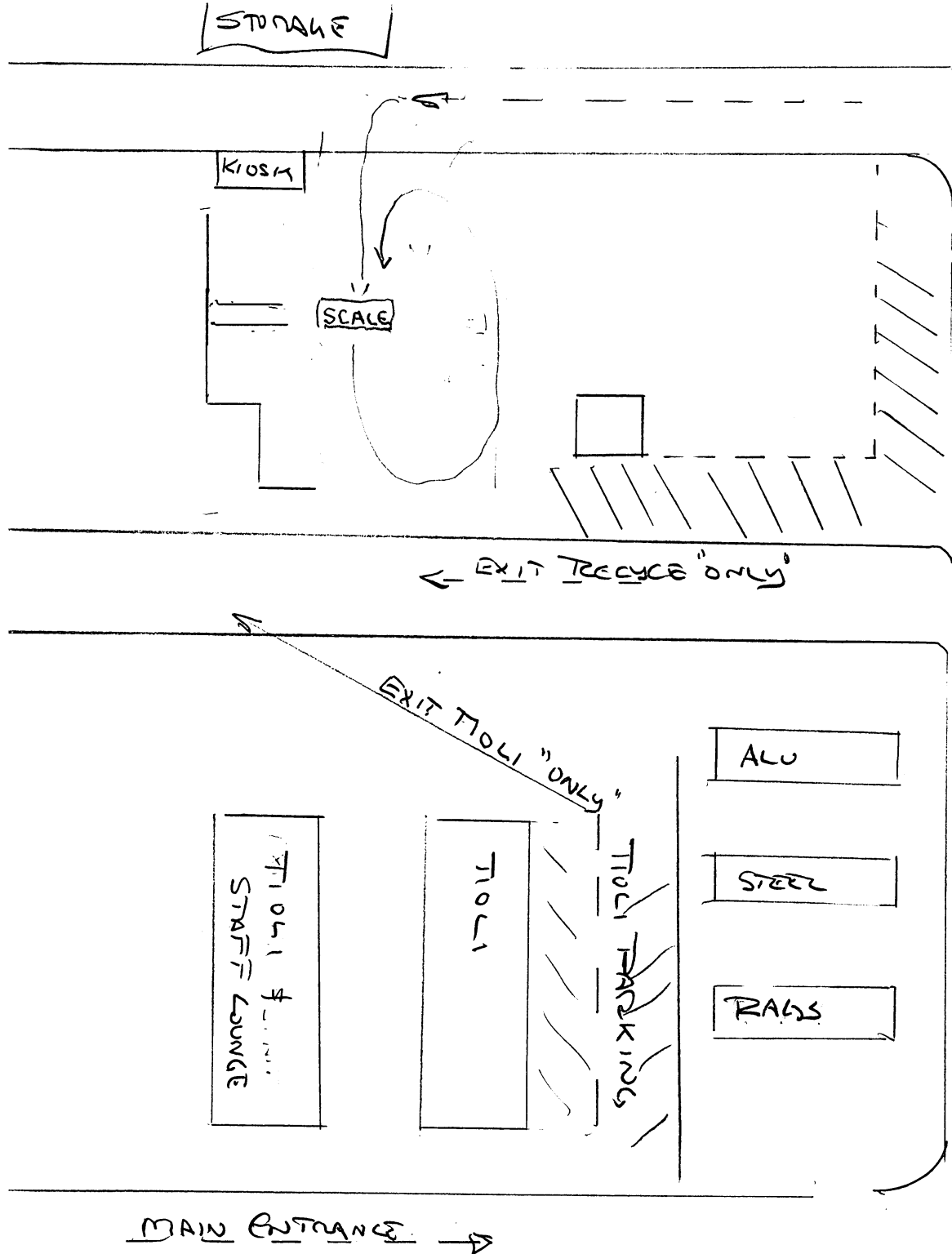

10/18/17

**APPENDIX 5 SEE NEXT PAGES**

| In Tons                          | Total Year 2013 | YTD Through   |               |               | September     |
|----------------------------------|-----------------|---------------|---------------|---------------|---------------|
|                                  |                 | 2014          | 2015          | 2016          | 2017          |
| Aluminum Cans                    | 2.7             | 2.79          | 2.45          | 2.92          | 3.52          |
| Cardboard                        | 48.0            | 41.01         | 47.59         | 48.95         | 56.77         |
| Commingled Recyclables           | 14.5            | 12.20         | 6.93          | -             | -             |
| E-Cycle                          | 5.0             | 5.16          | 4.36          | 5.07          | 4.11          |
| Ferrous Metals                   | 30.5            | 43.42         | 26.99         | 42.45         | 55.06         |
| Glass                            | 95.8            | -             | -             | -             | -             |
| Mixed Paper/Newsprint            | 81.5            | 86.17         | 65.33         | 74.98         | 65.82         |
| Non-Ferrous Metals               | 1.4             | 0.78          | 0.96          | 2.94          | 3.08          |
| Other                            | 4.9             | 7.94          | 11.14         | 11.64         | 13.38         |
| Plastics                         | 14.0            | 19.53         | 15.40         | 15.95         | 17.20         |
| <b>Recycle Subtotal</b>          | <b>298.3</b>    | <b>219.0</b>  | <b>181.2</b>  | <b>204.88</b> | <b>218.9</b>  |
| Garbage                          | 425.0           | 363.05        | 350.96        | 374.73        | 420.57        |
| Glass - reclamation project      | 15.0            | 72.00         | 85.50         | 98.38         | 96.51         |
| <b>Garbage/Glass Subtotal</b>    | <b>440.0</b>    | <b>435.0</b>  | <b>436.46</b> | <b>473.10</b> | <b>517.08</b> |
| <b>Grand Total Without TIOLI</b> | <b>738.3</b>    | <b>654.0</b>  | <b>617.61</b> | <b>677.98</b> | <b>736.01</b> |
| TIOLI Intake                     | -               | 21.04         | 98.62         | 110.83        | 125.98        |
| TIOLI Discards                   | -               | -             | (2.00)        | (4.47)        | (4.85)        |
| <b>Grand Total With TIOLI</b>    | <b>-</b>        | <b>675.08</b> | <b>714.23</b> | <b>784.35</b> | <b>857.14</b> |

| Full Year Annual Rate | 2013 Full Year Rate | 2014 Full Year Rate | 2015 Full Year Rate | 2016 Full Year Rate |
|-----------------------|---------------------|---------------------|---------------------|---------------------|
| Recycle/Reuse         | 40%                 | 37%                 | 39%                 | 40%                 |
| Garbage/Glass         | 60%                 | 63%                 | 61%                 | 60%                 |

| Year to Date  |      |  |               |      |
|---------------|------|--|---------------|------|
| Garbage/Glass | Tons |  | Recycle/Reuse | Tons |
| 2014          | 435  |  | 2014          | 240  |
| 2015          | 436  |  | 2015          | 278  |
| 2016          | 473  |  | 2016          | 311  |
| 2017          | 517  |  | 2017          | 340  |

| Garbage/Glass | %   |  | Recycle/Reuse | %   |
|---------------|-----|--|---------------|-----|
| 2014          | 64% |  | 2014          | 36% |
| 2015          | 61% |  | 2015          | 39% |
| 2016          | 60% |  | 2016          | 40% |
| 2017          | 60% |  | 2017          | 40% |

| 2017 Monthly in lbs              | January        | February       | March          | April          | May            | June           | July           | August         | September      | October  | November | December | Total          | Tons          |
|----------------------------------|----------------|----------------|----------------|----------------|----------------|----------------|----------------|----------------|----------------|----------|----------|----------|----------------|---------------|
| Aluminum Cans                    | 940            | -              | 457            | 924            | 442            | 428            | 1,252          | 1,705          | 885            | -        | -        | -        | 7,033          | 3.52          |
| Cardboard                        | 15,395         | 5,636          | 9,462          | 11,907         | 10,084         | 12,318         | 17,407         | 15,887         | 15,445         | -        | -        | -        | 113,541        | 56.77         |
| Commingle Recyclables            | -              | -              | -              | -              | -              | -              | -              | -              | -              | -        | -        | -        | -              | -             |
| E-Cycle                          | -              | -              | -              | 6,412          | -              | -              | 1,800          | -              | -              | -        | -        | -        | 8,212          | 4.11          |
| Ferrous Metal                    | 12,500         | 319            | 11,140         | 14,700         | 12,360         | 12,240         | 11,880         | 22,160         | 12,820         | -        | -        | -        | 110,119        | 55.06         |
| Mixed Paper                      | 16,040         | -              | 25,200         | 16,534         | 17,960         | -              | 20,020         | 18,840         | 17,040         | -        | -        | -        | 131,634        | 65.82         |
| Non-Ferrous Metal                | 97             | 371            | 377            | 383            | -              | 4,434          | 92             | 97             | 311            | -        | -        | -        | 6,162          | 3.08          |
| Other                            | 1,134          | 4,256          | 3,390          | 170            | 4,145          | 3,192          | 5,844          | 1,488          | 3,149          | -        | -        | -        | 26,768         | 13.38         |
| Plastics                         | 3,678          | 1,681          | 1,112          | 5,629          | 2,490          | 5,132          | 4,391          | 5,822          | 4,461          | -        | -        | -        | 34,396         | 17.20         |
| <b>Recycle Subtotal</b>          | <b>49,784</b>  | <b>12,263</b>  | <b>51,138</b>  | <b>56,659</b>  | <b>47,481</b>  | <b>37,744</b>  | <b>62,686</b>  | <b>65,999</b>  | <b>54,111</b>  | <b>-</b> | <b>-</b> | <b>-</b> | <b>437,865</b> | <b>218.93</b> |
| Garbage                          | 74,700         | 70,750         | 84,740         | 74,880         | 85,560         | 87,120         | 139,880        | 112,960        | 110,540        | -        | -        | -        | 841,130        | 420.6         |
| Glass - reclamation project      | 27,680         | 14,080         | 16,270         | 15,680         | 17,750         | 18,240         | 44,960         | 20,100         | 18,260         | -        | -        | -        | 193,020        | 96.5          |
| <b>Garbage/Glass Subtotal</b>    | <b>102,380</b> | <b>84,830</b>  | <b>101,010</b> | <b>90,560</b>  | <b>103,310</b> | <b>105,360</b> | <b>184,840</b> | <b>133,060</b> | <b>128,800</b> | <b>-</b> | <b>-</b> | <b>-</b> | <b>#####</b>   | <b>517.08</b> |
| <b>Grand Total Without TIOLI</b> | <b>152,164</b> | <b>97,093</b>  | <b>152,148</b> | <b>147,219</b> | <b>150,791</b> | <b>143,104</b> | <b>247,526</b> | <b>199,059</b> | <b>182,911</b> | <b>-</b> | <b>-</b> | <b>-</b> | <b>#####</b>   | <b>736.01</b> |
| TIOLI Intake                     | 22,376         | 16,567         | 19,478         | 29,659         | 24,746         | 36,099         | 31,429         | 32,681         | 38,925         | -        | -        | -        | 251,960        | 125.98        |
| TIOLI Discards                   | (483)          | (605)          | (915)          | (795)          | (2,010)        | (1,335)        | (1,471)        | (456)          | (1,620)        | -        | -        | -        | (9,690)        | (4.85)        |
| <b>Grand Total with TIOLI</b>    | <b>174,057</b> | <b>113,055</b> | <b>170,711</b> | <b>176,083</b> | <b>173,527</b> | <b>177,868</b> | <b>277,484</b> | <b>231,284</b> | <b>220,216</b> | <b>-</b> | <b>-</b> | <b>-</b> | <b>#####</b>   | <b>857.14</b> |

| 2016 Monthly in lbs   | January | February | March  | April | May    | June   | July   | August | September | October | November | December | Total   | Tons  |
|-----------------------|---------|----------|--------|-------|--------|--------|--------|--------|-----------|---------|----------|----------|---------|-------|
| Aluminum Cans         | 480     | 460      | 541    | -     | 906    | 425    | 877    | 802    | 1,339     | 459     | 980      | 496      | 7,765   | 3.88  |
| Cardboard             | 11,437  | 8,553    | 3,932  | 5,206 | 15,522 | 10,319 | 15,378 | 11,102 | 16,445    | 9,137   | 13,692   | 7,202    | 127,944 | 63.97 |
| Commingle Recyclables | -       | -        | -      | -     | -      | -      | -      | -      | -         | -       | 8,560    | -        | 8,560   | 4.28  |
| E-Cycle               | -       | -        | -      | 4,936 | -      | -      | 5,200  | -      | -         | -       | 5,200    | -        | 15,336  | 7.67  |
| Ferrous Metal         | -       | -        | 23,700 | -     | 13,640 | 10,600 | 11,200 | 11,170 | 14,580    | 23,600  | 13,580   | -        | 122,070 | 61.04 |

|                                  |                |                |                |                |                |                |                |                |                |                |                |                |                |                 |
|----------------------------------|----------------|----------------|----------------|----------------|----------------|----------------|----------------|----------------|----------------|----------------|----------------|----------------|----------------|-----------------|
| Mixed Paper                      | -              | 24,320         | 23,240         | -              | 22,180         | 21,260         | 19,100         | 19,360         | 20,500         | -              | 27,260         | 19,640         | 196,860        | 98.43           |
| Non-Ferrous Metal                | 508            | -              | -              | 4,200          | 728            | -              | -              | 441            | -              | 483            | 485            | 67             | 6,912          | 3.46            |
| Other                            | 4,300          | 2,202          | 150            | 322            | 4,485          | 2,855          | 1,825          | 240            | 6,891          | 152            | 2,265          | 2,685          | 28,372         | 14.19           |
| Plastics                         | 2,783          | 2,394          | 1,955          | 2,037          | 6,455          | 1,930          | 4,250          | 4,777          | 5,318          | 2,168          | 4,308          | 3,642          | 42,017         | 21.01           |
| <b>Recycle Subtotal</b>          | <b>19,318</b>  | <b>37,929</b>  | <b>53,537</b>  | <b>16,701</b>  | <b>63,916</b>  | <b>47,389</b>  | <b>57,830</b>  | <b>47,892</b>  | <b>63,173</b>  | <b>35,999</b>  | <b>76,330</b>  | <b>33,732</b>  | <b>555,836</b> | <b>277.92</b>   |
| Garbage                          | 53,480         | 57,160         | 79,000         | 69,380         | 93,960         | 102,340        | 99,140         | 89,500         | 105,490        | 117,240        | 54,000         | 74,860         | 995,531        | 497.8           |
| Glass - reclamation project      | 14,790         | 15,000         | -              | 30,990         | 17,130         | 19,310         | 47,350         | 33,010         | 19,170         | 10,670         | 21,340         | 16,720         | 245,480        | 122.7           |
| <b>Garbage/Glass Subtotal</b>    | <b>68,270</b>  | <b>72,160</b>  | <b>79,000</b>  | <b>100,370</b> | <b>111,090</b> | <b>121,631</b> | <b>146,490</b> | <b>122,320</b> | <b>124,660</b> | <b>127,910</b> | <b>75,340</b>  | <b>91,580</b>  | <b>#####</b>   | <b>620.33</b>   |
| <b>Grand Total Without TIOLI</b> | <b>87,778</b>  | <b>110,089</b> | <b>132,537</b> | <b>117,071</b> | <b>173,106</b> | <b>169,039</b> | <b>204,320</b> | <b>170,402</b> | <b>189,733</b> | <b>163,909</b> | <b>132,670</b> | <b>125,312</b> | <b>#####</b>   | <b>898.43</b>   |
| TIOLI Intake                     | 23,016         | 20,540         | 19,871         | 21,514         | 24,200         | 20,556         | 33,061         | 30,137         | 28,765         | 23,938         | 21,649         | 9,836          | 277,083        | 138.54          |
| TIOLI Discards                   | (2,000)        | (776)          | (151)          | (965)          | (1,154)        | (775)          | (1,005)        | (705)          | (1,410)        | (2,375)        | (645)          | (925)          | (12,886)       | (6.44)          |
| <b>Grand Total with TIOLI</b>    | <b>108,794</b> | <b>129,853</b> | <b>152,257</b> | <b>137,620</b> | <b>198,033</b> | <b>188,820</b> | <b>236,376</b> | <b>199,834</b> | <b>217,088</b> | <b>185,472</b> | <b>172,674</b> | <b>134,223</b> | <b>#####</b>   | <b>1,030.53</b> |

| 2015 Monthly in lbs            | January       | February       | March          | April          | May            | June           | July           | August         | September      | October        | November       | December       | Total          | Tons          |
|--------------------------------|---------------|----------------|----------------|----------------|----------------|----------------|----------------|----------------|----------------|----------------|----------------|----------------|----------------|---------------|
| Aluminum Cans                  | -             | 541            | -              | -              | -              | 1,789          | 867            | 1,270          | 431            | 326            | 482            | 523            | 6,419          | 3.21          |
| Cardboard                      | 7,713         | 9,049          | 9,769          | 5,817          | 6,325          | 16,033         | 13,216         | 13,194         | 14,054         | 8,407          | 9,464          | 9,831          | 124,981        | 62.49         |
| Commingled Recyclables         | -             | -              | 8,400          | -              | -              | -              | 5,460          | -              | -              | -              | -              | 8,400          | 22,260         | 11.13         |
| E-Cycle                        | -             | -              | -              | -              | 3,522          | -              | -              | 5,204          | -              | -              | 4,783          | -              | 13,319         | 6.73          |
| Ferrous Metal                  | -             | 8,800          | -              | -              | 22,600         | -              | -              | 22,584         | -              | -              | 24,829         | 300            | 79,113         | 39.56         |
| Mixed Paper                    | -             | 21,800         | -              | 23,440         | -              | 22,320         | 21,280         | 21,260         | 20,560         | 24,220         | -              | 22,688         | 177,368        | 88.78         |
| Non-Ferrous Metal              | 1,291         | 123            | -              | -              | -              | 234            | -              | 183            | 97             | 73             | 236            | 3,000          | 5,237          | 2.62          |
| Other                          | 3,037         | 560            | 3,895          | 1,055          | 2,707          | 6,364          | 2,354          | 1,430          | 884            | 2,979          | 679            | 1,265          | 27,209         | 13.60         |
| Plastics                       | 3,943         | 2,380          | 422            | -              | 1,627          | 9,349          | 4,153          | 4,852          | 4,074          | 2,684          | 3,036          | 3,486          | 40,006         | 20.00         |
| TIOLI Intake                   | 10,881        | 12,093         | 13,332         | 22,039         | 31,568         | 27,476         | 30,007         | 24,977         | 24,871         | 21,736         | 16,542         | 14,626         | 231,147        | 125.07        |
| TIOLI Discards                 | -             | (160)          | (775)          | (183)          | (470)          | (1,094)        | (533)          | (514)          | (266)          | (930)          | (1,579)        | (218)          | (6,722)        | (3.36)        |
| <b>Recycle/Resuse Subtotal</b> | <b>26,865</b> | <b>55,186</b>  | <b>35,043</b>  | <b>52,168</b>  | <b>67,879</b>  | <b>82,471</b>  | <b>76,804</b>  | <b>94,440</b>  | <b>64,705</b>  | <b>59,495</b>  | <b>58,472</b>  | <b>63,901</b>  | <b>739,727</b> | <b>369.86</b> |
| Garbage                        | 54,310        | 56,400         | 91,020         | 72,800         | 66,700         | 79,300         | 121,040        | 88,880         | 71,460         | 72,780         | 78,460         | 78,480         | 931,820        | 465.91        |
| Glass - reclamation project    | 16,000        | -              | 16,000         | 16,000         | 16,000         | 13,260         | 47,370         | 29,010         | 17,360         | 12,470         | 19,330         | 30,360         | 233,160        | 117.91        |
| <b>Garbage/Glass Subtotal</b>  | <b>70,310</b> | <b>56,400</b>  | <b>107,020</b> | <b>88,800</b>  | <b>82,700</b>  | <b>94,460</b>  | <b>168,610</b> | <b>117,890</b> | <b>88,820</b>  | <b>85,231</b>  | <b>97,790</b>  | <b>109,400</b> | <b>#####</b>   | <b>583.82</b> |
| <b>Grand Total</b>             | <b>97,365</b> | <b>111,586</b> | <b>142,063</b> | <b>140,968</b> | <b>131,769</b> | <b>176,931</b> | <b>247,314</b> | <b>212,330</b> | <b>153,525</b> | <b>144,935</b> | <b>156,262</b> | <b>173,320</b> | <b>#####</b>   | <b>953.68</b> |

| 2014 Monthly In lbs            | January        | February      | March          | April          | May            | June           | July           | August         | September      | October        | November       | December       | Total          | Tons          |
|--------------------------------|----------------|---------------|----------------|----------------|----------------|----------------|----------------|----------------|----------------|----------------|----------------|----------------|----------------|---------------|
| Aluminum Cans                  | 1,017          | 427           | -              | 443            | 449            | 543            | 870            | 932            | 895            | 431            | -              | 989            | 6,996          | 3.50          |
| Cardboard                      | 10,845         | 3,569         | 8,939          | 6,077          | 8,643          | 4,884          | 16,796         | 9,040          | 13,232         | 7,341          | 6,315          | 11,032         | 106,932        | 53.50         |
| Commingled Recyclables         | 10,520         | -             | -              | -              | -              | -              | 8,980          | -              | 4,900          | -              | -              | -              | 24,400         | 12.20         |
| E-Cycle                        | -              | -             | -              | 3,273          | -              | -              | -              | -              | 7,041          | -              | -              | 2,320          | 14,536         | 7.30          |
| Ferrous Metal                  | 1,360          | -             | -              | 35,310         | -              | -              | 33,480         | -              | 16,680         | -              | 16,700         | -              | 103,720        | 32.90         |
| Mixed Paper                    | 26,936         | 17,944        | 2,846          | 47,318         | -              | 21,040         | 38,620         | -              | 17,640         | 22,260         | 21,360         | 22,480         | 238,444        | 119.20        |
| Non-Ferrous Metal              | -              | -             | 371            | 988            | -              | -              | -              | -              | 198            | 194            | 365            | 4,127          | 6,243          | 3.10          |
| Other                          | -              | 3,431         | 825            | 2,125          | 80             | 7,268          | 2,025          | 40             | 80             | 605            | 2,373          | 2,735          | 21,628         | 10.50         |
| Plastics                       | 4,603          | 1,277         | 3,199          | 4,245          | 5,462          | 2,919          | 8,798          | 3,030          | 5,535          | 2,177          | 2,445          | 1,632          | 45,341         | 22.60         |
| TIOLI Intake                   | -              | -             | -              | -              | -              | -              | -              | 28,922         | 13,160         | 13,212         | 25,331         | 12,333         | 94,858         | 47.40         |
| <b>Recycle/Resuse Subtotal</b> | <b>55,281</b>  | <b>26,667</b> | <b>16,532</b>  | <b>102,859</b> | <b>14,634</b>  | <b>36,654</b>  | <b>109,569</b> | <b>41,964</b>  | <b>81,280</b>  | <b>46,614</b>  | <b>73,256</b>  | <b>61,814</b>  | <b>663,098</b> | <b>331.30</b> |
| Garbage                        | 78,940         | 56,420        | 70,720         | 61,460         | 72,040         | 94,720         | 99,310         | 91,680         | 100,800        | 76,160         | 85,700         | 53,620         | 941,760        | 471.00        |
| Glass - reclamation project    | 16,000         | -             | 16,000         | 16,000         | 16,000         | 16,000         | 32,000         | 16,000         | 16,000         | 16,000         | 16,000         | 16,000         | 192,000        | 96.00         |
| <b>Garbage/Glass Subtotal</b>  | <b>94,940</b>  | <b>56,420</b> | <b>86,720</b>  | <b>77,460</b>  | <b>88,040</b>  | <b>110,720</b> | <b>131,310</b> | <b>107,680</b> | <b>116,800</b> | <b>92,160</b>  | <b>101,700</b> | <b>69,620</b>  | <b>#####</b>   | <b>567.00</b> |
| <b>Grand Total</b>             | <b>131,221</b> | <b>83,087</b> | <b>103,271</b> | <b>180,319</b> | <b>102,674</b> | <b>147,374</b> | <b>241,069</b> | <b>149,644</b> | <b>198,080</b> | <b>138,774</b> | <b>176,956</b> | <b>131,434</b> | <b>#####</b>   | <b>898.30</b> |

Notes on 2017

Other is composed of Aluminum Foil, Electric Motors, Electric Wire, Fluorescent lights, Lead Acid Batteries, Rechargeable Batteries, Oil Waste, Refrigerators, Textiles, Tires, Non-Ecycle Electronics